

Health in Marginalized Population Group Research Unit (HMG)

คณะแพทยศาสตร์

คณะเภสัชศาสตร์

คณะสาธารณสุขศาสตร์

คณะสถาปัตยกรรมศาสตร์ ผังเมืองและนฤมิตศิลป์

มหาวิทยาลัยมหาสารคาม

Outline

- Definitions
- Experiences
- Potential research questions

Marginalized Population Groups

“Marginalization and social exclusion influence health”

“Marginalization show health risks resulting from discrimination, environmental dangers, unmet subsistence needs, severe illness, trauma and restricted access to health care”

Lynam&Cowley(2007). Understanding marginalization as a social determinant of health. *Critical Public Health*, June 2007; 17(2):137-149

What Is Health System?

“ A health system consists of all the organizations, institutes, resources and people whose primary purpose is to improve health

This includes efforts to influence determinants of health as well as more direct health-improvement activities”

WHO (2010). Monitoring the building blocks of health systems: A handbook of indicators and their measurement strategies.

WHO Health Systems Framework

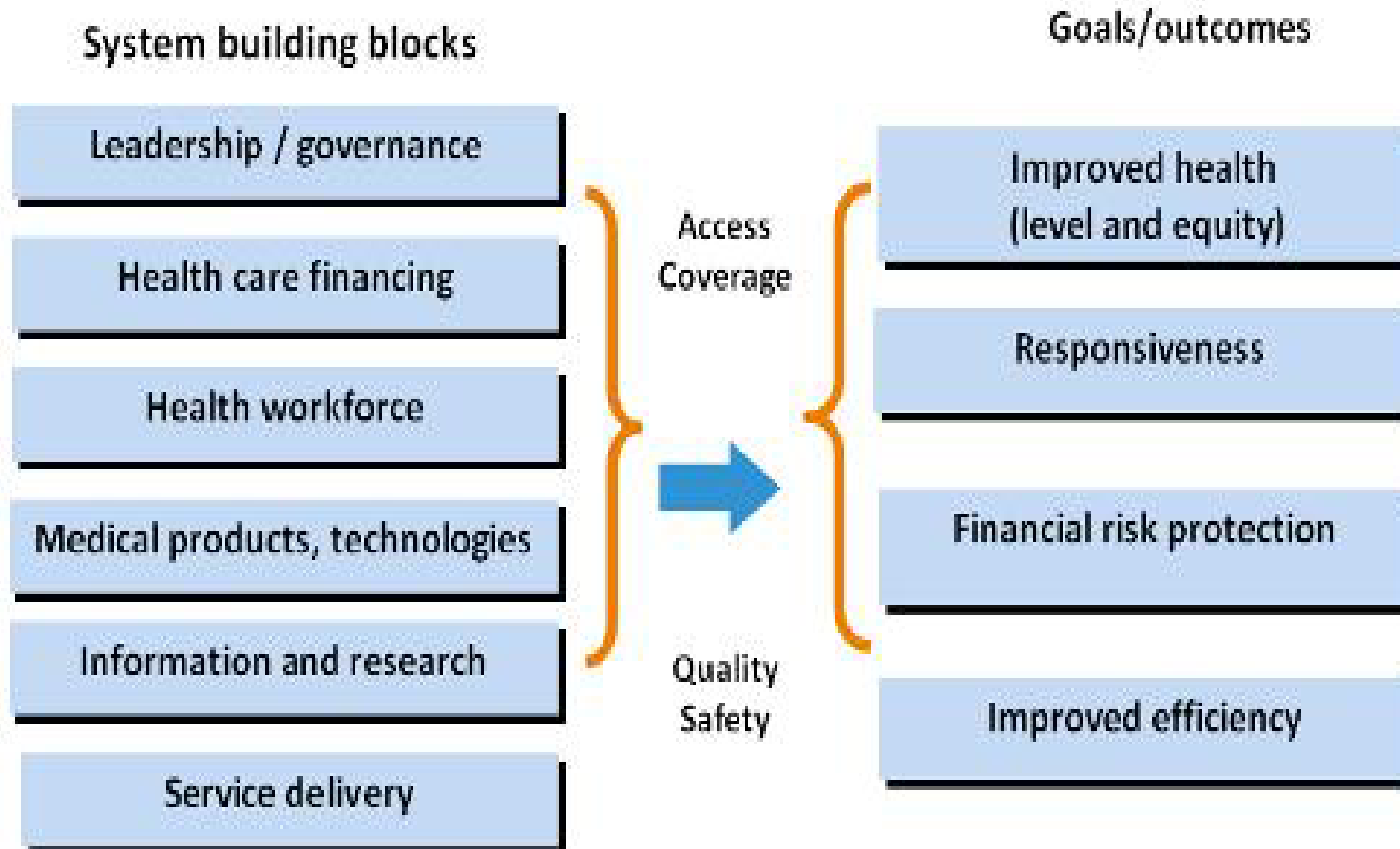

ประสบการณ์การดำเนินงานในพื้นที่

Using ICF to develop a capability-oriented database of persons with disabilities: A case study in Nakornpanom province, Thailand

Sirinart Tongsiri, MD PhD

Wachara Riewpaiboon, MD

Objectives

- To develop a capability-oriented database using a questionnaire based on ICF
- This database could be used to plan, monitor and evaluate rehabilitation programs implemented in a community

ICF framework

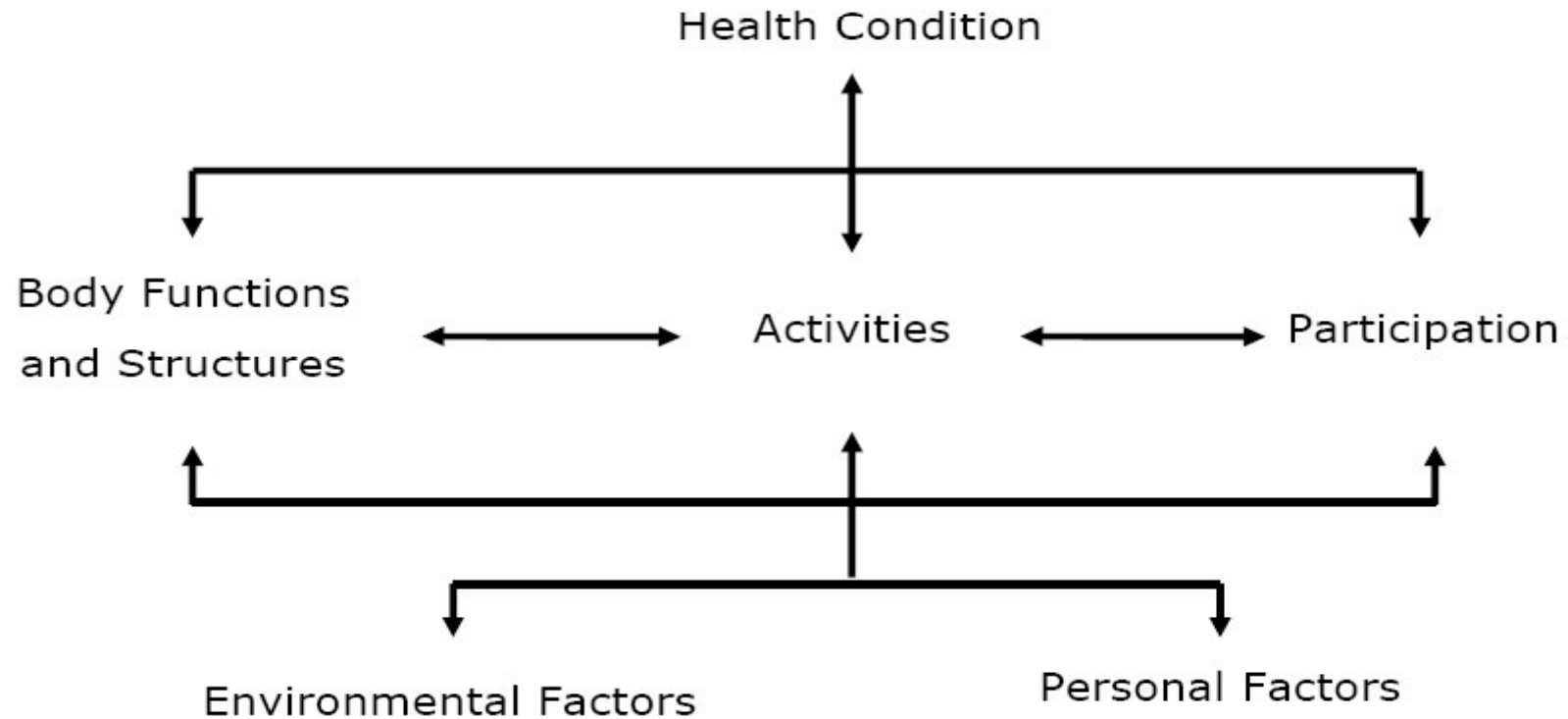

Background

- No harmonization of PWDs data among various local organizations
- Fragmented rehabilitation services
- Limitation of rehabilitation programs monitoring and evaluation

An ICF-based questionnaire

46 ICF codes

- 2 codes of body functions
- 24 codes of activities&participations
- 20 environmental factors

2 pilot studies

Results

- 2 weeks with 16 interviewers
- 1,007 participants with 56.4% male
- Interview duration 12 (10.9-12.7) mins
- Data entry and analysed with the Stata11 program

Results

Number of PWDs: body-function based

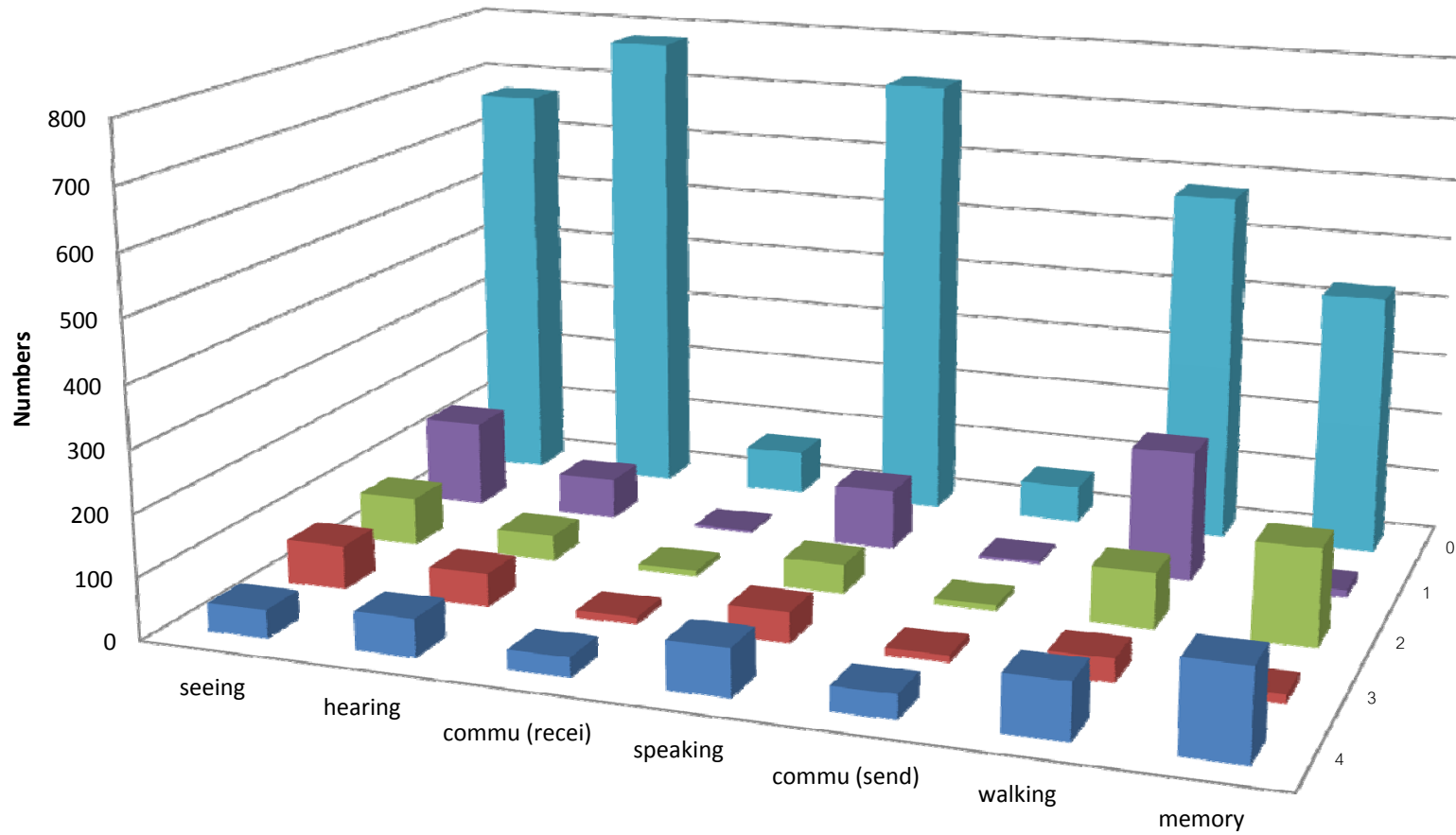

Results

Number of PWD: AP-based

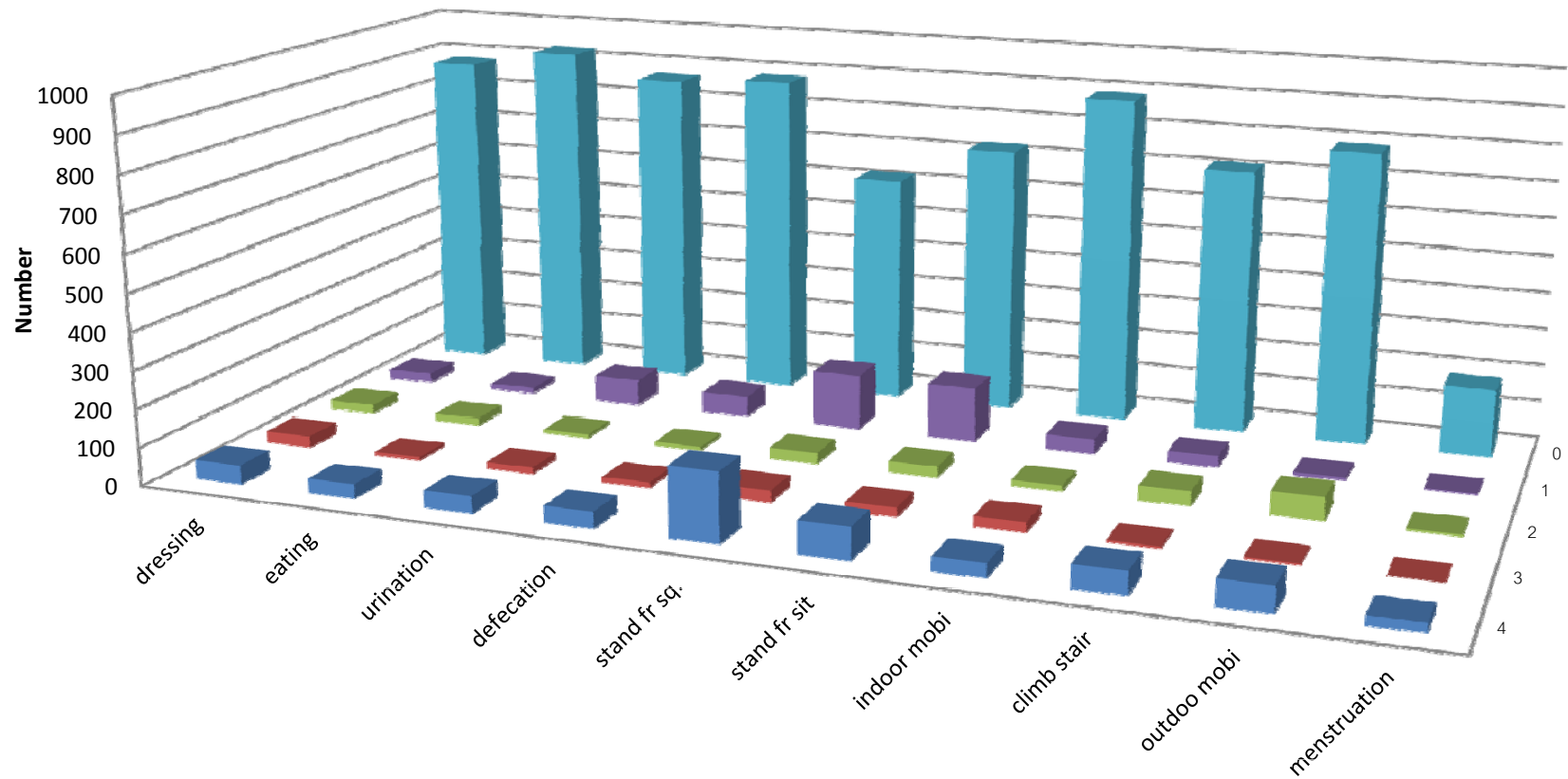

Need for environmental modifications

Environmental modifications	Number
No Need	647 (64.7%)
Unmet Need	243 (24.3%)
Done	109 (10.9%)

Education

Educational level (before disability)	Number
Never	52(7.64%)
Continuing educated	4 (0.59%)
Before bachelor degree	621 (99.85%)
Bachelor degree	1 (0.15%)

Unemployment

Number and type	\geq qualifier 2
≥ 2 body functions types	77 (29.84%)
≥ 3 body functions types	42 (16.28%)
≥ 2 AP types	60 (23.26%)
≥ 3 AP types	45 (17.44%)

Outputs

- More insights of persons with disabilities
- Operational definitions towards improving quality of life
- Tools to harmonize different organizations to align with interdisciplinary approach

Policy Recommendations

The Housing and Environment Modifications for PWDs in Thailand



Sirinart Tongsiri MD PhD
Chanuttha Ploylearmsang PhD
Katanyu Hawsuthisima
Mahasarakham University, Thailand

ICF framework

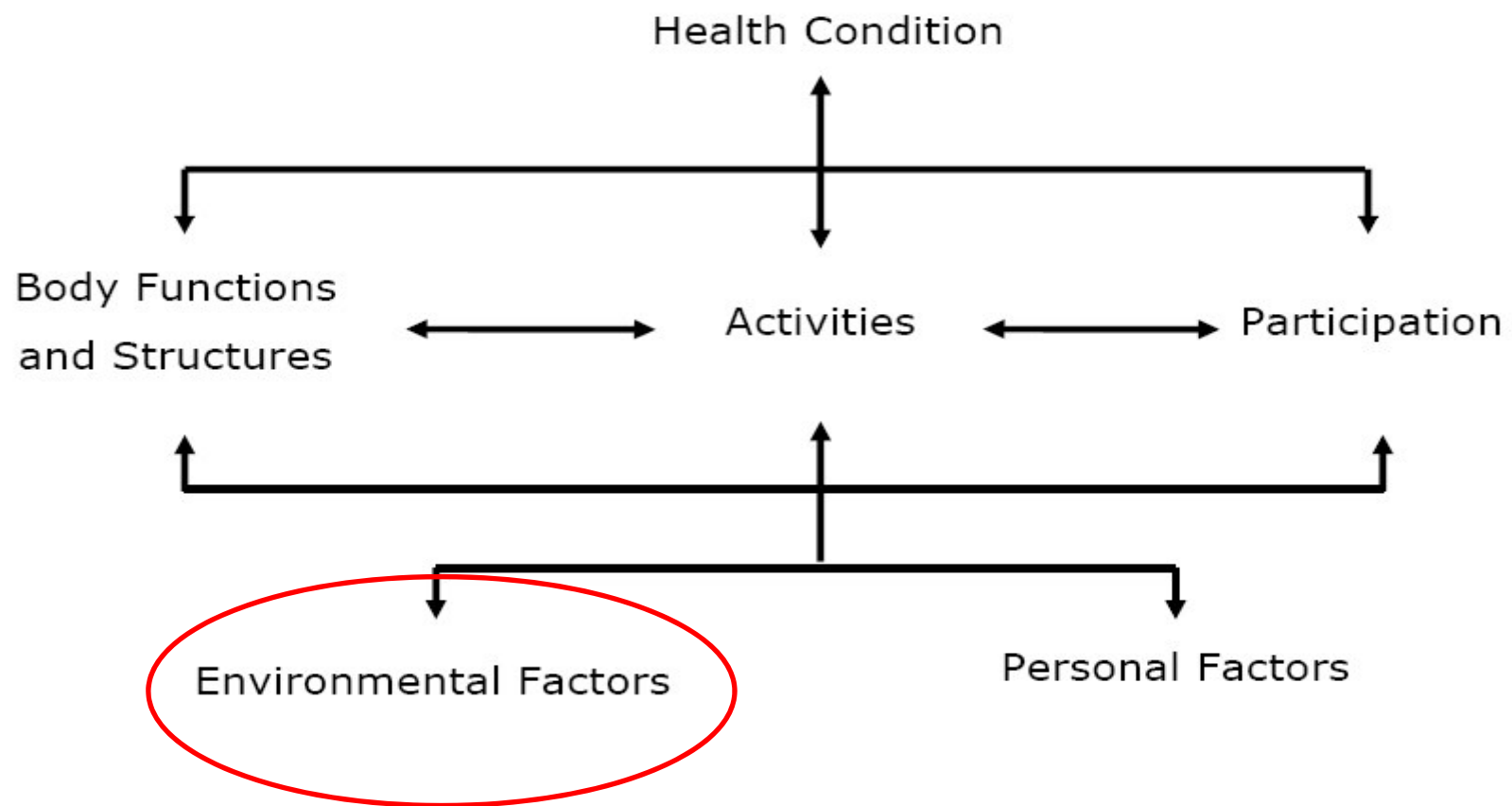

Community-based Rehabilitation (CBR)

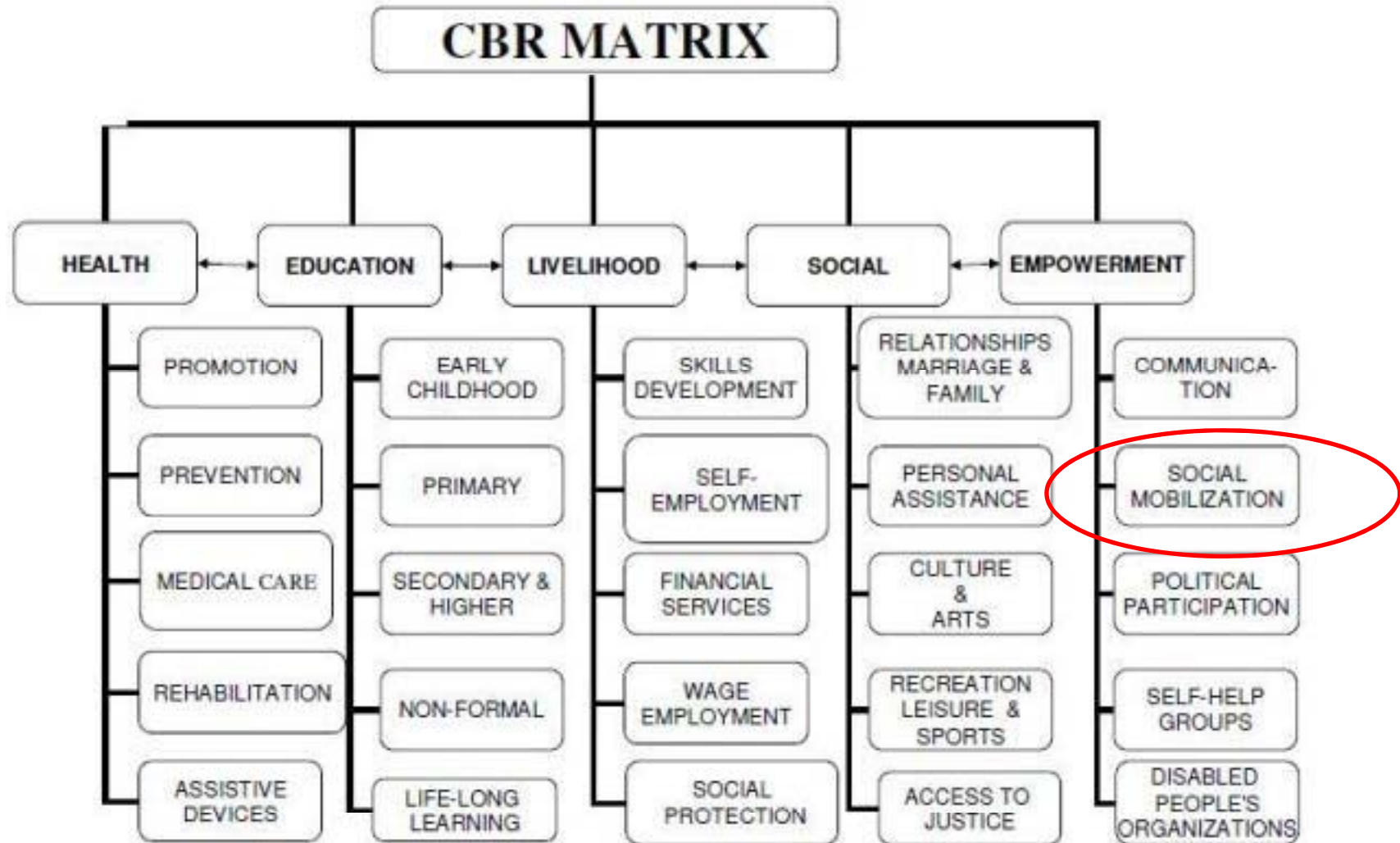

The PWDs Empowerment Act 2007

Section 20 PWDs shall be entitled to access and use public facilities including other welfare and assistance provided by the State as follows:

(10) Modification of their housing, environment, provision of a helper or any other services under criteria and methods prescribed in the Rules of the Commission

Challenges

- Limitation of knowledge
- Fragmented services provisions
- Financial constraints



The Evaluation of Costs and Outcomes of the Housing and Environment Modifications for PWDs Project

Aims:

1. Policy recommendations
2. How the resources should be mobilized



Methods

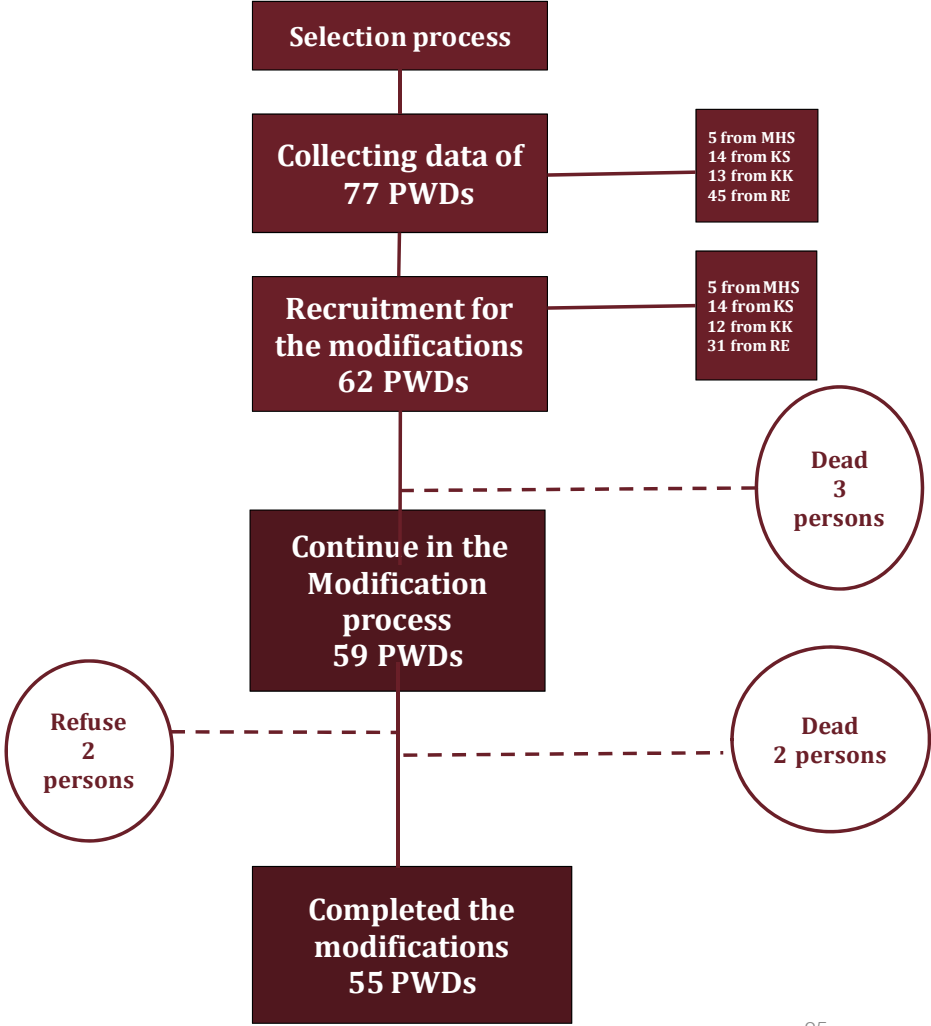

Methods

- Capacity Building



Results

Design

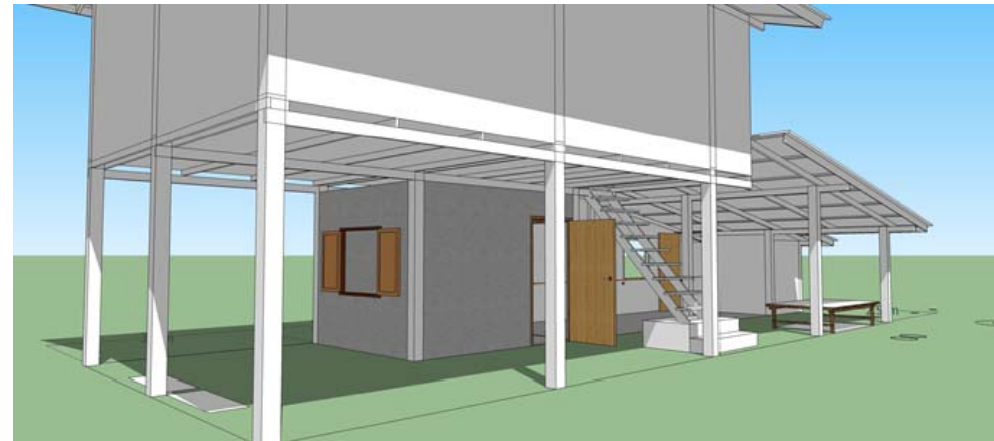
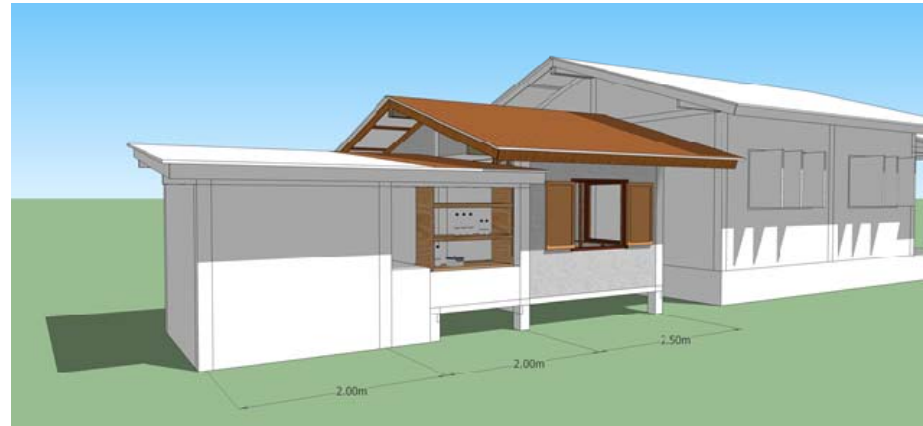

Results

- Construction



Outcome evaluation



Outcome evaluation



Policy recommendations

1. Capacity building: medical care and social care staffs
2. Financial resource management: pooling and allocation processes
3. Selection of eligible PWDs: criteria
4. Design and cost calculation: multidisciplinary
5. Building and Monitoring Qol evaluation and Knowledge Management

Case manager: Community Administration Office

Long-term care

- การดูแลระยะยาวด้านสาธารณสุขสำหรับผู้สูงอายุที่มีภาวะพึ่งพิงในพื้นที่ (Long-term care) ในระบบหลักประกันสุขภาพแห่งชาติ
- ประกาศคณะกรรมการหลักประกันสุขภาพแห่งชาติ เรื่อง การกำหนดหลักเกณฑ์เพื่อสนับสนุนให้อปท. ดำเนินงาน และบริหารจัดการกองทุนหลักประกันสุขภาพในระดับท้องถิ่นหรือพื้นที่ (ฉบับที่ 2)

How to

- medical care + social care
- Capacity building
- Communications
- Logistics: administration, financial, etc.
- Data management
- Planning and evaluation
- Recommendations

etc.

Potential research question

- Effective health policy implementation to reduce health risks and enhance equity in marginalized population groups
 - Contextual factors
 - Belief and cultural factors
 - ICF, CBR and health systems framework